

# BARNs AND OTHER RURAL ARCHITECTURE: A CATALOG NOV. 2019

CLASSIC BOOKS AND EPHEMERA  
LANSDOWNE, PA  
[classicbooksandephemera.com](http://classicbooksandephemera.com)

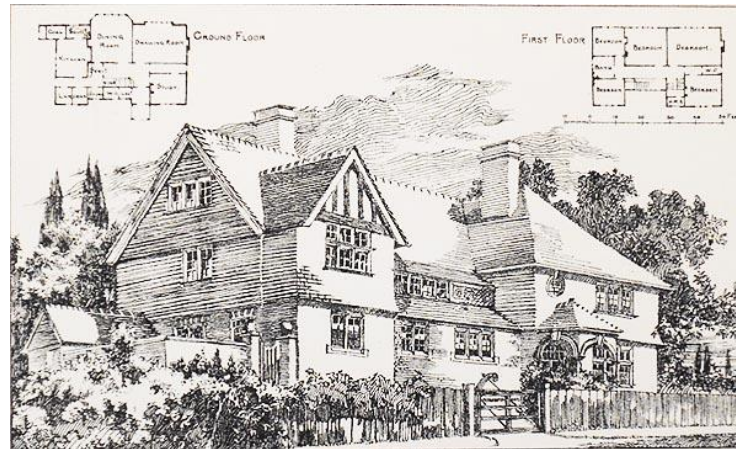

ADDITIONAL PHOTOS OF MOST ITEMS ARE AVAILABLE ON OUR WEB SITE.

We accept payment by credit card, check, or Paypal. We offer discounts to libraries and dealers.

Pennsylvania residents pay state sales tax. We ship worldwide.

Contact us by phone 215 823-9607 or email [info@classicbooksandephemera.com](mailto:info@classicbooksandephemera.com)

## BARNs

1. DePol, John. **Not Barn Again: Four Engravings.** Council Bluffs, Iowa: Yellow Barn Press, 1997. [16] p.: wood engravings by John DePol; 27 cm. Brown paper wrappers printed in red. Text by Neil Shaver. This is one of a limited edition of 150 copies hand-printed by Neil Shaver and Joe Shaver at the Yellow Barn Press. With a small errata slip tipped in on the colophon page. In Near Fine Condition: upper corners lightly creased. A crisp and bright copy of this very scarce item. (#000876) \$125.00

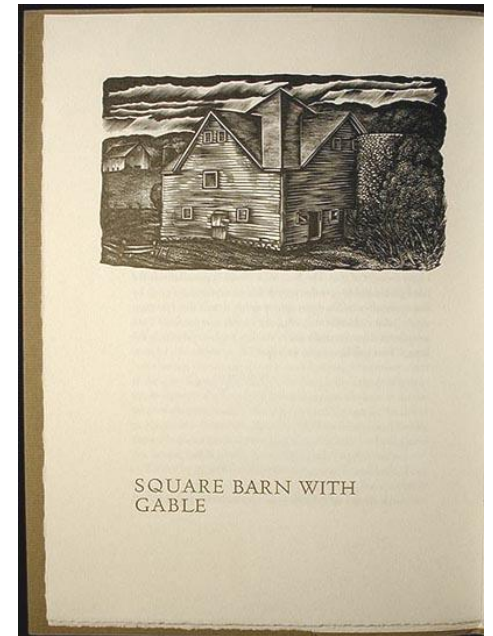

2. Stair, J. William. **Pennsylfawnisch Ditesch Scheiers: "Pennsylvania Dutch Barns to You"** [original photographs of brick-end barns]. 43 black-and-white 8 x 10 photographs, which include 24 that were used in *The Brick-End Barns of the Pennsylvania Dutch: A Record of Early American Architecture* by J. William Stair (Lancaster, Pa.: Pennsylvania Dutch Folklore Center, Franklin and Marshall College, 1954), originally published in *The Dutchman*, vol. 6, no. 2. Housed, loose, in a 10 x 15 scrapbook with gilt-stamped cover title. The photographs were never attached to the scrapbook pages. The photographs were taken or acquired by Stair in the years prior to the publication of his article on brick-end barns. There are pencilled notations on the backs of many of them with identification of the style and/or location. Three are identified as having been taken by Robert J. Lewis or Robert C. Smith. In Near Fine Condition: two have discoloration on the back of the photographs, not impacting the images; otherwise, clean and bright. (#007276) \$250.00





## COTTAGES AND OTHER RURAL ARCHITECTURE

**3. Suburban Development and Colony Life: Being an Article on the Organization and Subdivision of Property, and the Thorough Planning of Small Individual Homesteads in *The Architectural Annual* vol. 2; Edited by Albert Kelsey: Issue for 1901.** Philadelphia: Architectural Annual, 1901. "Second Edition." 303 p.: illustrations, plans, views; 32 cm. Red cloth with gilt-stamped spine and cover titles; black ruled border on front cover. Black emblem on front cover with motto "Progress Before Precedent." Red endpapers. Title page in red and black. Front fixed endpaper bears blue-and-black bookplate of Edward A. Teitelman (d. 2010), doctor and architectural historian, signed Sellers. A heavy book; for international shipping, it will have to be sent by priority international. In Very Good Condition: edges slightly rubbed; closed tear of 3-cm. or less from lower edge of 3 leaves; clean and tight. (#006563) \$115.00



**4. Cutler, Thomas W. Cottages and Country Buildings designed by Thomas W. Cutler.** London: Horace Cox, 1896. 17, [87] p., 44 leaves of plates: plans, views; 19 x 28 cm. Faux vellum over boards with gilt-stamped cover title. Boards have bevelled edges. Floral patterned endpapers. Each plate is accompanied by one or two pages of descriptive text. Cutler's designs perfectly present late 19th-century English rural architecture from cottages of various sizes to a village corner shop to small and large country houses. The volume concludes with his design for the Princess Alice Memorial Hospital at Eastbourne. In Good+ Condition: corners are rubbed; back board is scraped; both hinges are weak; clean and tight. (#005173) \$145.00

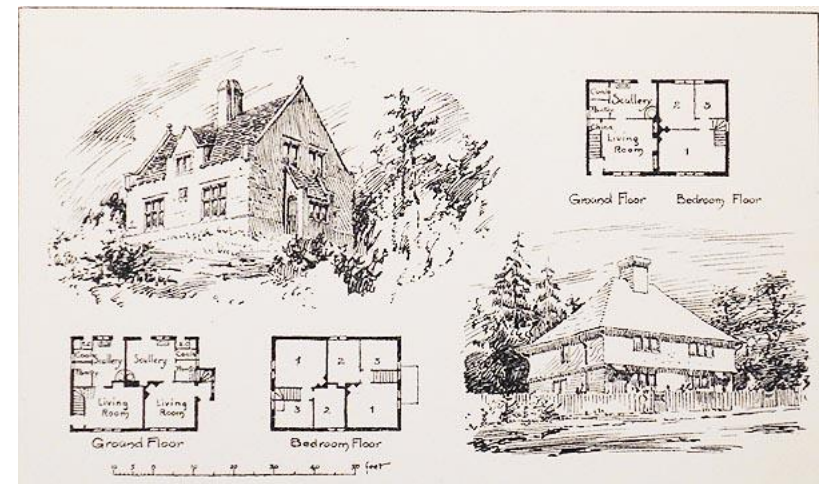

5. Johnson, S.W. (Stephen William). **Rural Economy: Containing a Treatise on Pisé Building; As recommended by the Board of Agriculture in Great Britain, with Improvements by the Author; On Buildings in general; Particularly on the Arrangement of those belonging to Farms; On the Culture of the Vine; and On Turnpike Roads.** New Brunswick, N.J.: Printed by William Elliot, for I. Riley & Co., New York, 1806. viii, 246, [6] p., 8 leaves of plates: table; 24 cm. Dark green 20th-century buckram with gilt-stamped spine title: "Pisé Building etc." Small binder's stamp on front fixed endpaper: "Bound by Alfred Smith & Co." Pages are untrimmed. Lacking first two leaves (title page and dedication to Thomas Jefferson). Early American Imprints, Series 2 (Shaw-Shoemaker), 10644. Hitchcock, 652. Contents include: On Pisé Building -- On Mud-Walling -- On Farm Houses, Out-Offices, etc. The author, Stephen William Johnson, was a British attorney who came to the United States about 1795, settling in New Brunswick, N.J. He dedicated this book, the first American work on rammed-earth construction, to Thomas Jefferson. In the first section, he drew heavily from work published in the 1790s by Francois Cointeraux (1740-1830). This book helped to popularize the use of rammed earth in the United States. The group of pise de terre (rammed earth) buildings that make up the Borough House Plantation in South

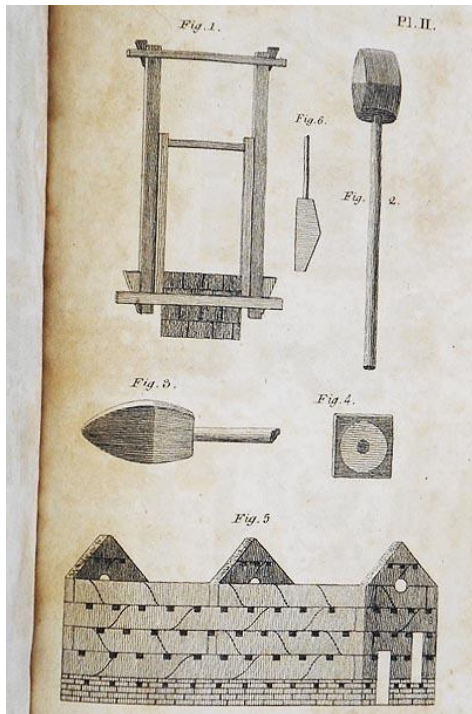

Carolina were built in 1821 following the techniques described in Johnson's book. Very scarce. Lacking first two leaves (title page and dedication to Thomas Jefferson); otherwise in Very Good Condition: old stain along lower edge of a few pages of text and 4 leaves of plates, where it just touches the lower edge of the illustration; otherwise, clean and tight. (#004549) \$125.00

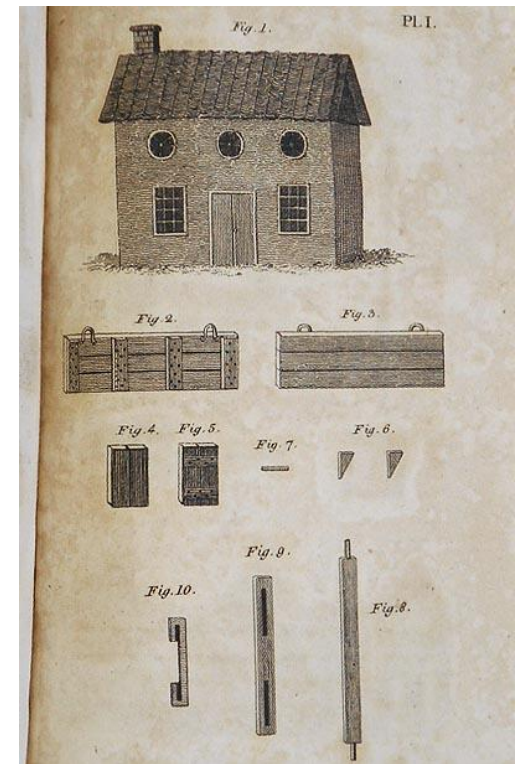



**6. Kerr, Robert. *The Gentleman's House; or, How to Plan English Residences, from the Parsonage to the Palace; with Tables of Accomodation and Cost, and a Series of Selected Plans.*** London: John Murray, 1864. xxi, [1], 484 p.: 44 plates of architectural plans (many folded); 23 cm. Original publisher's blue pebble-grain cloth with gilt-stamped spine title and blind-ruled borders on both boards. Dark green endpapers. Wood-engraved title vignette signed Osborne; 19 additional in-text illustrations, and in-text tables. First edition. Includes a history of domestic architecture in England from the 11th century onward, including castles and monasteries, as well as country estates. This influential work on mid-19th-century domestic architecture has been described by the Oxford Dictionary of National Biography as "the most lucid and encyclopaedic account available of mid-Victorian domestic planning." Final section includes detailed description of each plate. Very well illustrated. With an invoice indicating that this book was purchased in 1970 by architect Robert L. Raley. In Very Good- Condition: ends of spine

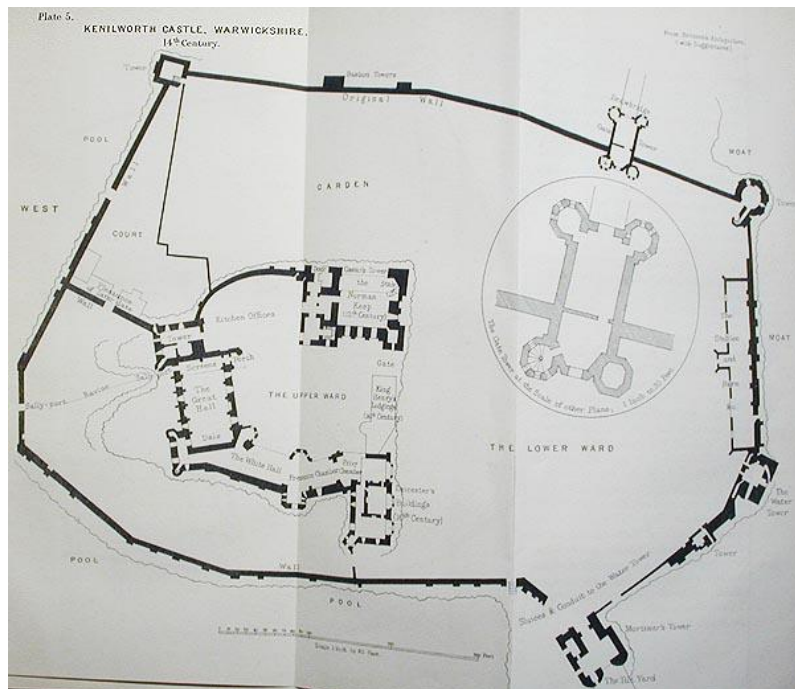
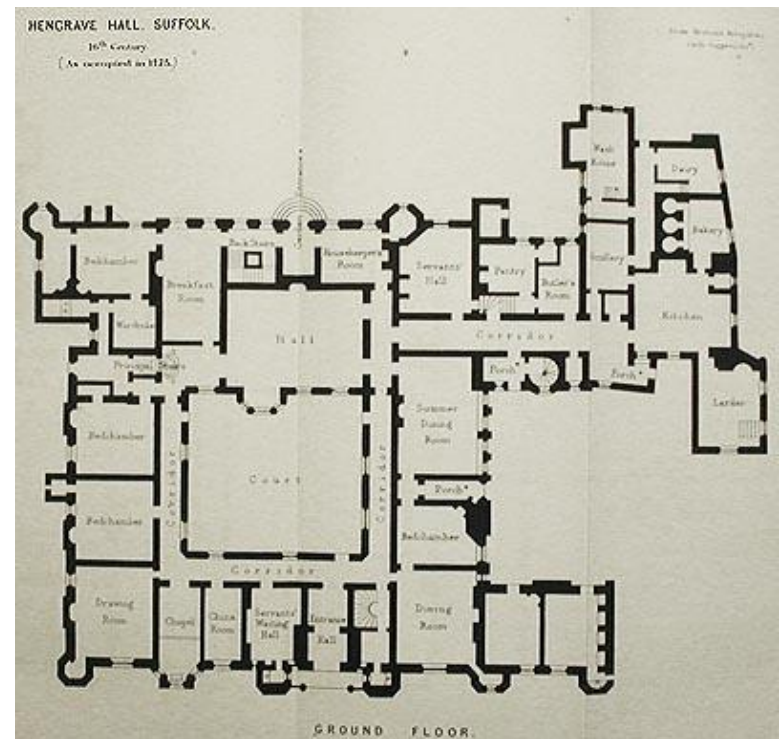

are fraying; spine is sunned; cover is lightly rubbed; plate 25 is partially detached, but intact; occasional light soiling; otherwise pages and plates are clean and tight. (#002349) \$525.00

7. Woodward, George E.; Thompson, Edward G. **Woodward's National Architect; Containing 1000 Original Designs, Plans and Details, To Working Scale, for the Practical Construction of Dwelling Houses for the Country, Suburb and Village; With Full and Complete Sets of Specifications and an Estimate of the Cost of Each Design.** New York: Geo. E. Woodward, 1869. "Designs, Plans & Details Engraved & printed by Korff Bros. New York." x, 31, [14], 16, 6, 6, 12, 16, [16] p., added engraved title page and 102 leaves of plates; 30 cm. Contemporary three-quarters morocco with marbled paper over boards. Six spine compartments between raised bands; gilt-tooled title in second compartments and decoration in remaining compartments. Without the pages of advertisements often found in this book. Former owner's name on front free endpaper verso:

Samuel J. Dornsife. Bookplate on front fixed endpaper indicating that the book belonged to the Victorian Society in America at the Athenaeum of Philadelphia and was from the Dornsife Collection. This has been stamped: "This book is no longer the property of the Athenaeum of Philadelphia." Pencilled note along gutter of plate no. 43. The only copy we have seen or see reference to that has 102 numbered plates, rather than 100. See Hitchcock 1435-1437, all calling for 100 plates. Samuel J. Dornsife (1916-1999) pioneered authentic restoration and recreation of 19th-century interiors for both houses and museums. In Good Condition: back board detached but present; front board partially detached; lacking leather from tail of spine; boards are rubbed; plates 88-102 reattached by old repair; otherwise, clean and solid; all plates are present. (#006009) \$185.00

